

WC

Domestic Lifting Station



Application

- The lifting station is suitable for pumping of wastewater off places in private dwellings and basements where wastewater cannot be led directly to the sewer by means of a natural downward slope.
- It is typically used for:
 - Renovation of offices or other commercial buildings
 - Wall-mounted toilets in basements below sewer level
 - Washing machines & dish washers
 - Toilets, wash basins, bathtubs and cabinet showers in the bathrooms where the location may be remote from the main soil pipe so that a natural slope cannot be established

Features

- Compact and slim for easy installation
- Automatic start and stop
- Top quality air switch and carbon filter from Germany
- Low noise
- Suitable for sewage water containing toilet paper and faeces with cutting blade

Operating Conditions

- Max. liquid temperature: 35°C
- Max. ambient temperature: 40°C
- PH value: 4 - 10
- The pump must not be used for strong chemicals or solvents

Identification Codes

WC - 560 A

- Symbol for Product Optimization
- Input Power (W)
- Domestic Lifting Station

Technical Data

MODEL	POWER	Q (m³/h)	0	0.3	0.6	0.9	1.2	1.5	1.8	2.1	2.4	3	3.3
Single Phase	W	HP	Q (l/min)	0	5	10	15	20	25	30	35	40	50
WC-560A	370	0.4	H (m)	6.5	6.1	5.7	5.3	4.9	4.5	4.1	3.7	3.3	2

Dimension

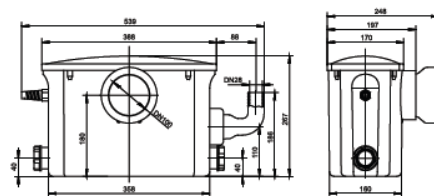

Hydraulic Performance Curves

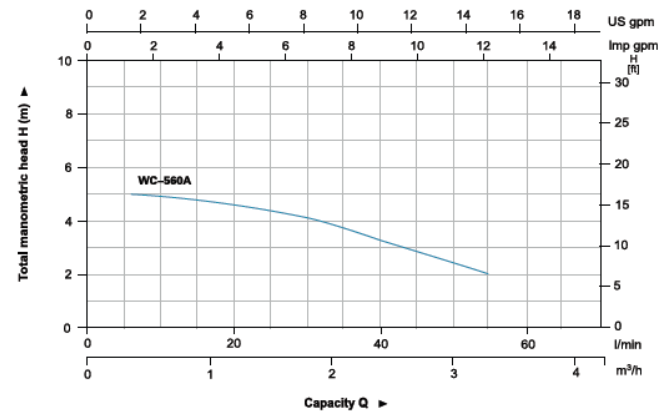

Materials Table

No.	Part	Material
1	Tank cover	ABS
2	Filter mesh	PP
3	Cutting blade	Steel
4	Top plate	PP
5	Shower	
6	Piston	
7	Stator	
8	Outlet cover	ØBP
9	Outlet	PVC
10	Feed tube	EVK
11	Shutter	
12	Radiator	ABS
13	Pump body	PP
14	Impeller	PCW
15	Stator shield	AlSi 304
16	Capacitor	
17	Air switch	
18	Capacitor cover	PP
19	Switch cover	PP

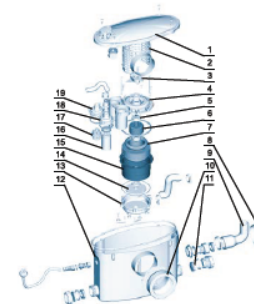

Package Information

Model	GW (Kgs)	L (mm)	W (mm)	H (mm)	Quantity (PCS/20 TEU)
WC-560A	7.4	587	212	280	864

